

REPAIR PARTS CATALOG

FOR

Brillion

MODELS
STT-8 THRU
STT-20

SPRING TOOTH HARROW

Model 02

ALL PARTS NOT LISTED ARE STANDARD HARDWARE

BRILLION IRON WORKS
BRILLION, WISCONSIN

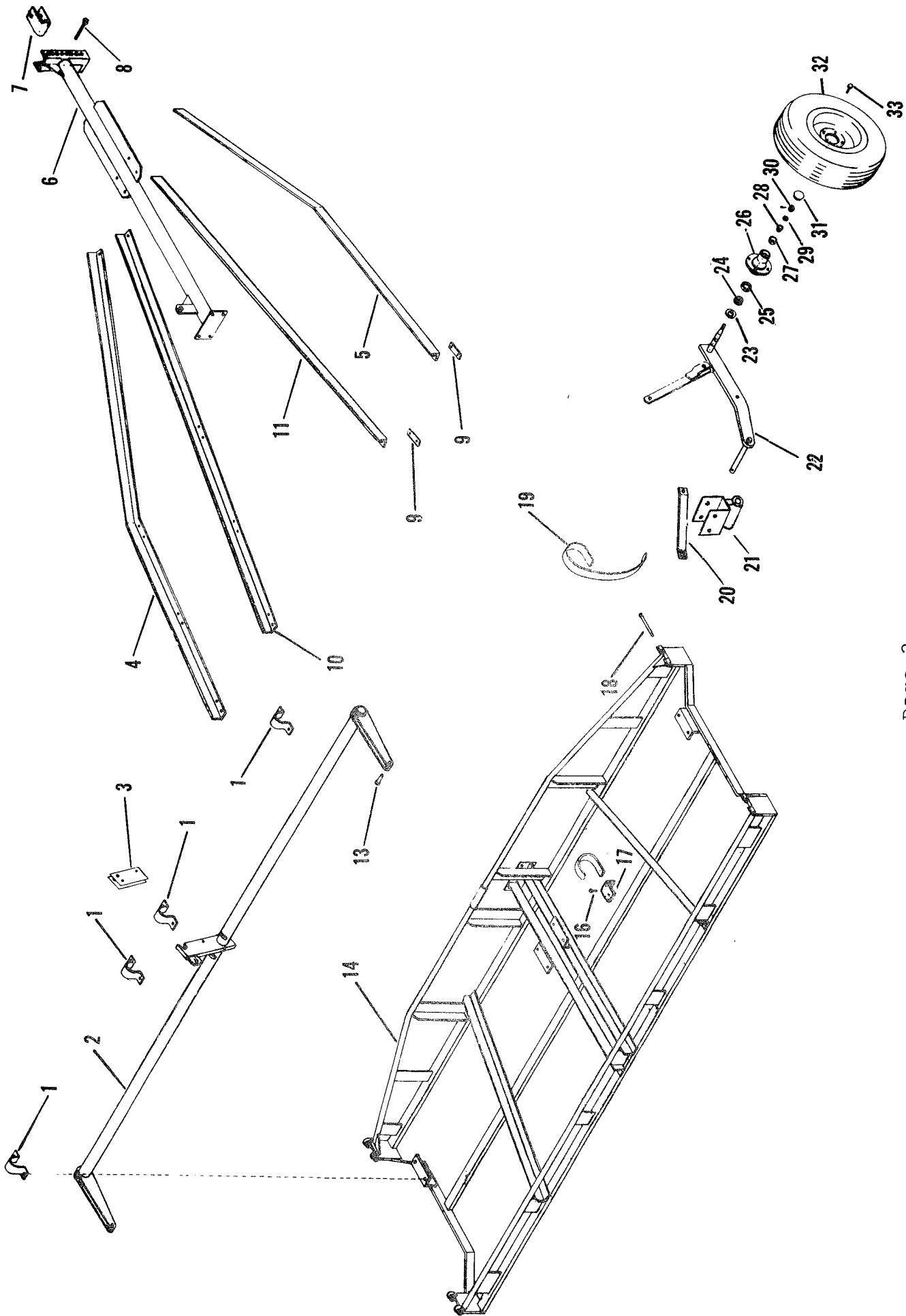

Index No.	Part No.	Description
1	3D-543	Bearing Clamp
2	3D-801	Rock Shaft Assembly - 8'
	3D-802	Rock Shaft Assembly - 10'
	3D-803	Rock Shaft Assembly - 12'
3	3D-798	Quick Hook-Up Assembly - 1-1/8 Long
4	5D-855	Frame Angle - L.H.
5	5D-854	Frame Angle - R.H.
6	5D-868	Drawbar
7	2D-349	Clevis
8	2D-488	Capscrew (3/4-10 NC x 5" Long, Heat Treated)
*	6C-729	Locknut (3/4-10 NC)
9	5C-78	Strap
10	5D-858	Frame Angle - L.H.
11	5D-859	Frame Angle - R.H.
13	2D-473	Clevis Pin (3/4" x 1-7/8" Long)
14	5D-835	Frame Assembly - 12'
16	5D-871	Capscrew - 1/2 x 3-1/2 (Grade 5)
*	5C-392	Locknut
17	5D-870	Spring Tooth Clamp - 2-1/2" Wide
	5D-836	Spring Tooth Clamp - 3" Wide
18	2D-475	Clevis Pin (3/4" x 5-1/2" Long)
19	6D-341	Spring Tooth
20	2D-871	Brace
*	7C-122	Machinery Bushing (18 Ga. x 1-1/4 I.D. x 1-7/8" O.D.)
21	5D-866	Axle Bearing
22	9D-686	Axle - R.H.
*	9D-687	Axle - L.H.
23	5C-910	Seal
24	5C-913	Bearing Cone (#LM67048)
25	5C-914	Bearing Cup (#LM67010)
26	5C-904	Wheel Hub
27	5C-912	Bearing Cup (#LM11910)
28	5C-911	Bearing Cone (#LM11949)
29	5C-907	Washer
30	5C-909	Slotted Nut
31	5C-908	Cap
32	6D-313	Wheel 14" - 4 Bolt (Less Tire & Tube)
	7D-931	Wheel 15" - 4 Bolt (Less Tire & Tube)
33	5C-100	Wheel Bolt
*	2D-551	Replacement Point (Can be used on worn spring teeth) 2 bolt holes
*	2C-628	Plow Bolt (3/8-16 NC x 1-1/2 R.H. Sq. Neck) 2 per pt.
		*Not Illustrated
	1C277	NUT
	1C183	LOCK WASHER
		> 2 per tooth

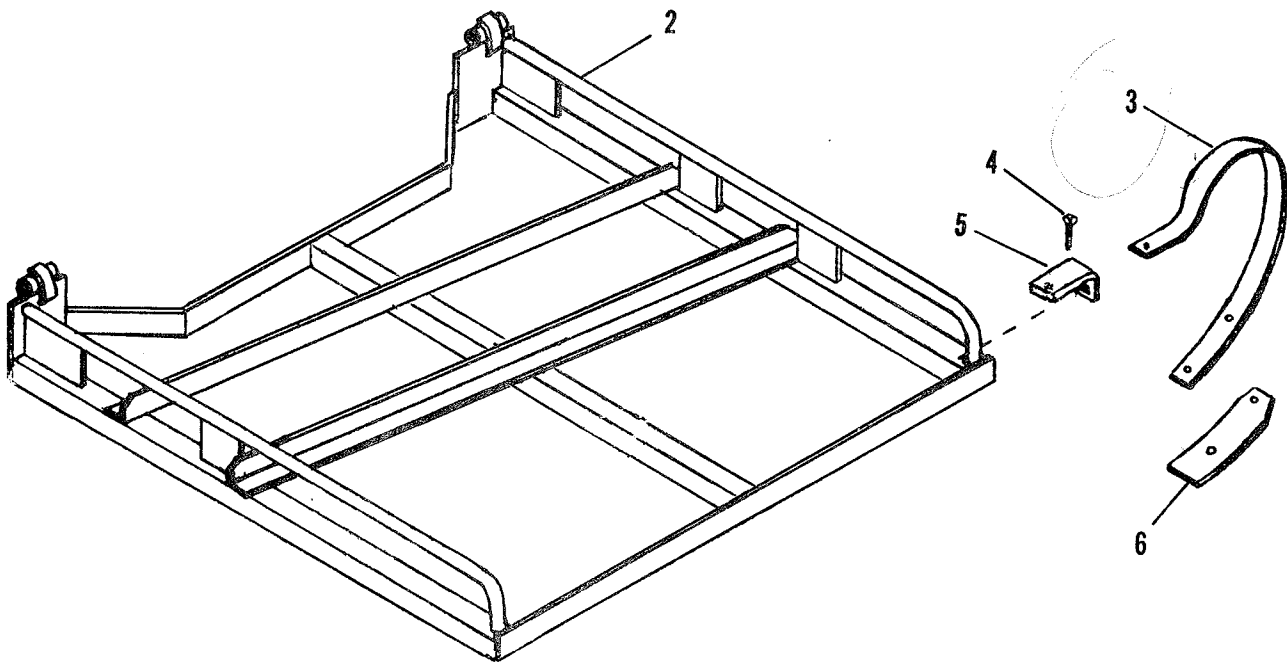
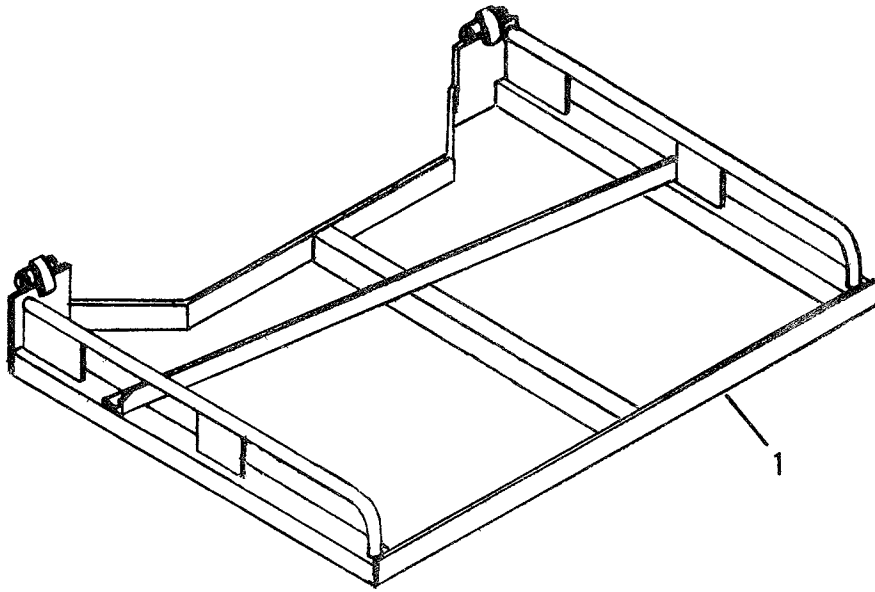

Index No.	Part No.	Description
1	5D-889	Frame Assembly - 3' L. H.
	5D-890	Frame Assembly - 3' R. H.
2	5D-839	Frame Assembly - 4' L. H.
	5D-840	Frame Assembly - 4' R. H.
3	6D-342	Spring - 3/8" Thick (used w/3' frame)
	6D-343	Spring - 7/16" Thick (used w/4' frame)
4	5D-871	Capscrew - 1/2 x 3-1/2, Heat Treated
*	5C-392	Locknut (1/2-13 NC)
5	5D-836	Spring Tooth Clamp (3' Wing)
	5D-838	Spring Tooth Clamp (4' Wing)
6	2D-360	Skid - 3" Wide (3' Wing)
	2D-864	Skid - 4" Wide (4' Wing)

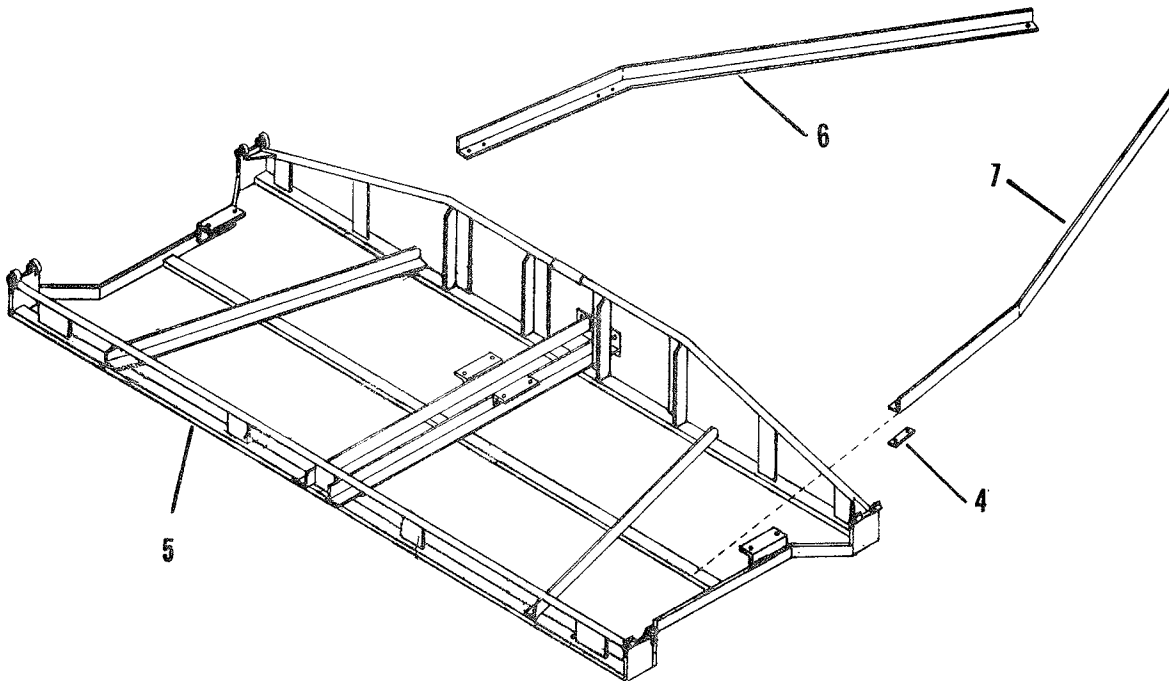
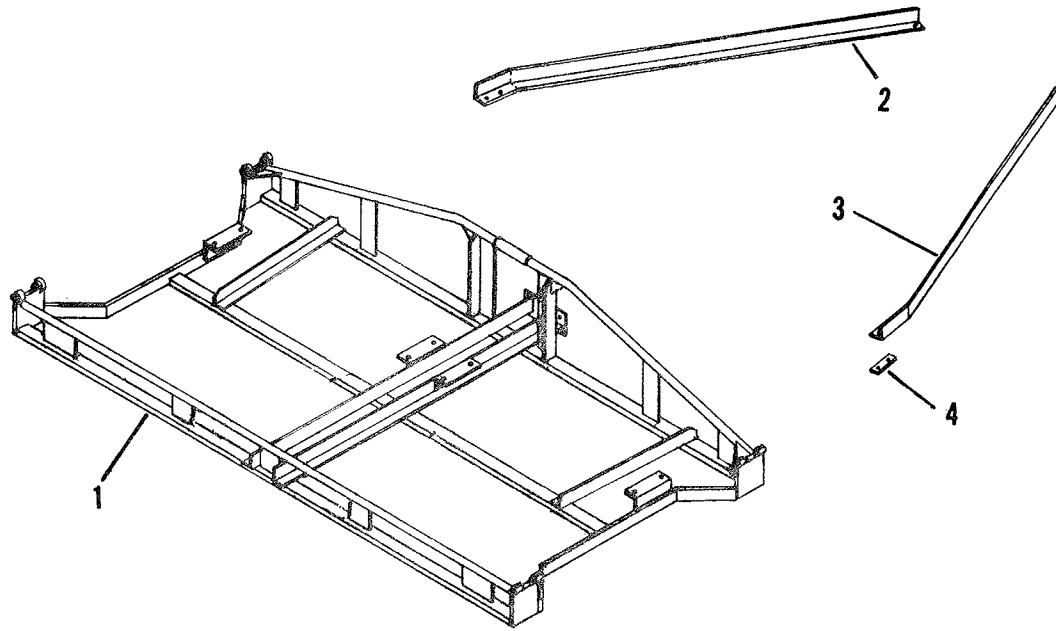

Index No.	Part No.	Description
1	5D-885	Frame Assembly - 8'
2	5D-901	Frame Angle - L.H.
3	5D-900	Frame Angle - R.H.
4	5C-78	Strap
5	5D-880	Frame Assembly - 10'
6	5D-902	Frame Angle - L.H.
7	5D-903	Frame Angle - R.H.

INSTRUCTIONS FOR ATTACHING SMOOTHENER KITS TO BRILLION SPRING TOOTH HARROWS

STT & STH MODELS

Smoothener kits are available in three and four foot widths. By using combinations of these kits the smoothener will fit all widths of Brillion Spring Tooth Harrows.

The three foot and four foot kits will fit their respective width wing sections. Use two four foot kits with an 8' center section; two three foot kits and one four foot kit with a ten foot center section; three four foot kits with a twelve foot center section.

HST MODELS

The smoothener kit for the HST-272 model harrows is made up of six 3' sections and a 5' section. Use the 5' section and two 3' sections on the center frame and two 3' sections on each wing frame. The kit for the HST-296 model harrows is made up of four 3' sections, two 4' sections and one 5' section. Use a 5' section and two 3' sections on the center frame and a 4' and 3' section on each wing frame.

Note the stop pads used on HST models (symbol 9 in illustration). They can be engaged or disengaged by sliding them forward or rearward respectively. When engaged, they will provide more ground clearance for transport. See views below.

ALL MODELS

1. Lay out the (5) 3D-269, 3D-270 and 8D-290 spike tooth bar assemblies behind the spring tooth harrow.
2. Attach two (4) 3D-268 channel assemblies to each (5) spike tooth bar assembly with the (8) 2D-735 U-bolts.
3. Attach a (2) 7D-765 bracket to each (4) channel assembly with a 1/2-13 NC x 4-1/2" bolt, washer and (3) 5C-392 locknut. DO NOT TIGHTEN NUT COMPLETELY. The channel assembly and bracket must pivot, so the smoothener will be free to float.
4. Attach the (2) 7D-765 brackets to the spring tooth harrow rear frame channel with the (1) 3D-273 U-bolts (for STH models) or the (1) 5D-921 U-bolts (for STT, STC and HST models).
5. Set the spike teeth to a desired angle and tighten the (8) 2D-735 U-bolts.

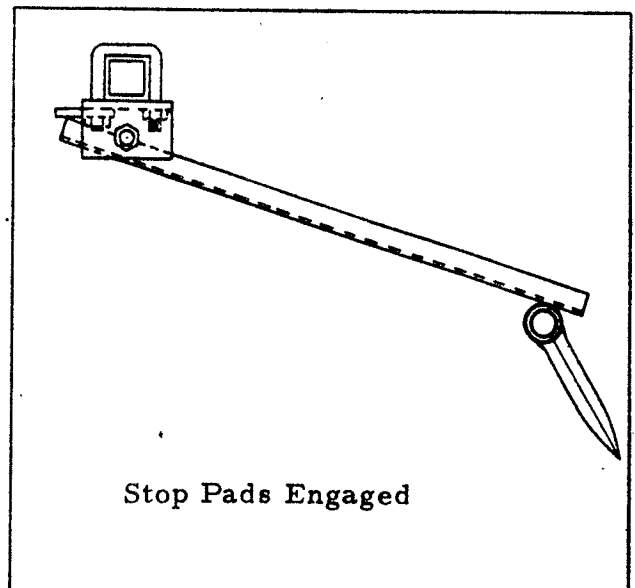
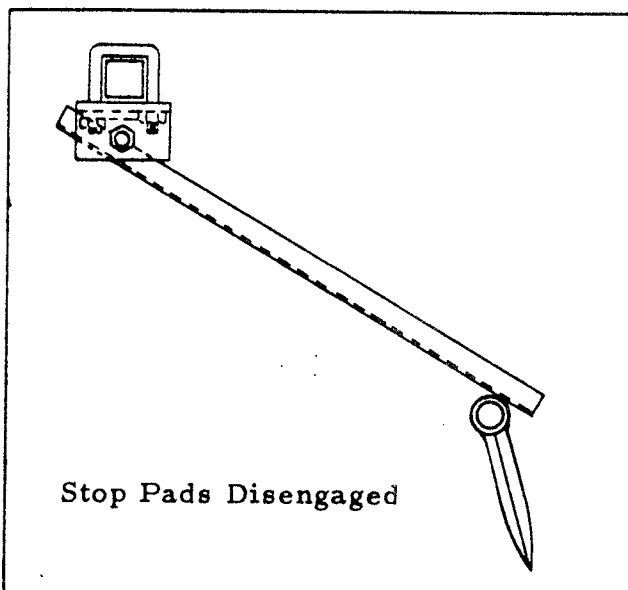

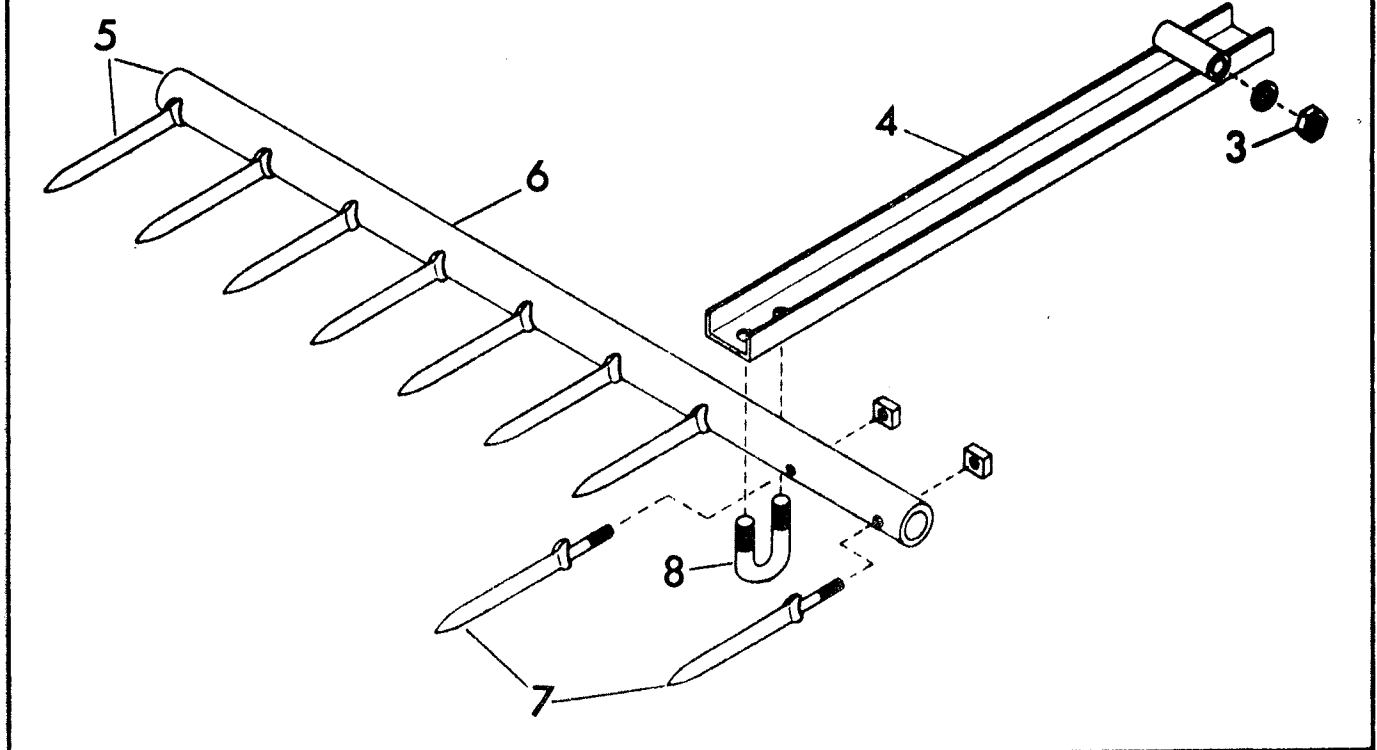
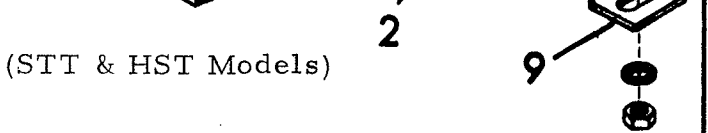
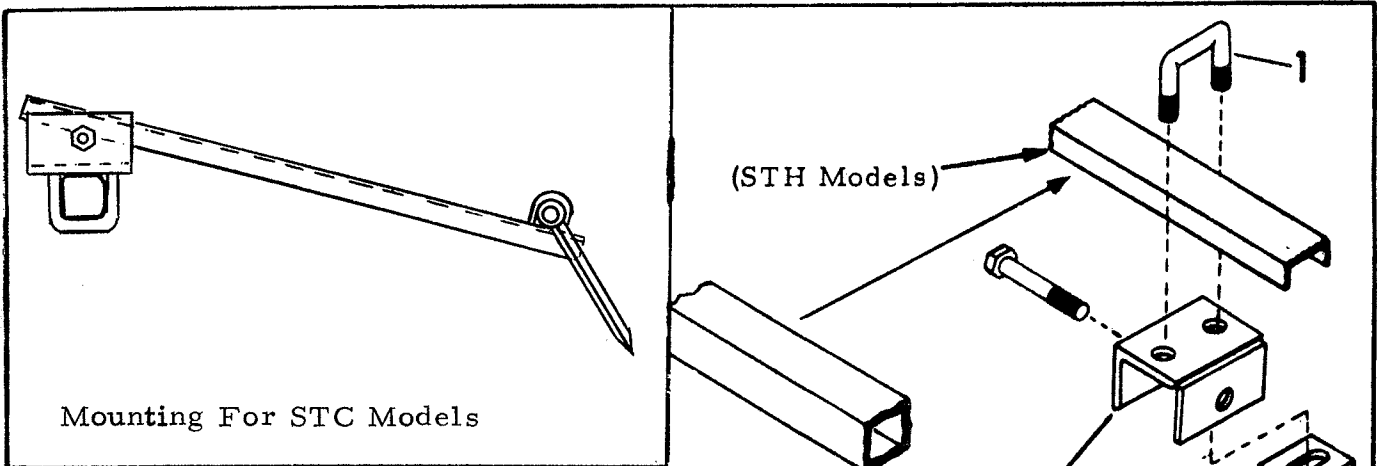

Sym.	Part No.	Description
1	5D-921	U-Bolt (STT & HST Models)
	3D-273	U-Bolt (STH Models)
2	7D-765	Bracket
3	5C-392	Stover Locknut
4	3D-268	Channel Assembly
5	3D-269	3' Spike Tooth Bar Assembly
	3D-270	4' Spike Tooth Bar Assembly
	8D-290	5' Spike Tooth Bar Assembly
6	3D-265	Pipe - 34" Long
	3D-266	Pipe - 46" Long
	8D-289	Pipe - 58" Long
7	3D-263	Spike Tooth
8	2D-735	U-Bolt
9	7D-771	Stop Pad (HST Models only)